

TotalZap TZ4

User Manual



Version 2.4

SCE Technologie © 2020

Contents

0	Introduction	1
0.1	The Concept	1
0.2	Installation	1
0.3	Configuration	2
1	TAB 1 - Dr. Hulda Clark Zapper	4
1.1	Fixed Sequences	4
1.2	Programmable Sequences	4
1.3	Stopwatch	5
1.4	Oscilloscope	5
2	TAB 2 - Dr. Royal Rife Frequency Generator	6
2.1	Database	6
2.2	Frequencies	6
2.3	Stopwatch	7
2.4	Oscilloscope	7
3	TAB 3 - Manual Frequency Generator	8
3.1	Frequency Selector	8
3.2	Stopwatch	8
4	TAB 4 - Creation	9
4.1	Create Yours	9
4.2	How to add a name	10
4.3	How to add a frequency	10
5	TAB 5 - Relaxation	11
6	Other	12
6.1	Total Security	12
6.2	Disclaimer	12
6.3	Warranty	12
6.4	Contact Us	12
7	Technical Data	13

0 Introduction

0.1 The Concept

First of all, thank you very much for choosing our system. We hope that it will provide you with exceptional service for many years and will fully meet your expectations.

This system is basically a closed WiFi mini-network consisting of an Android tablet and a dedicated frequency generator with inside a WiFi transmitter in "Access Point" mode, that is to say, it acts as a router. The distance between the two can vary considerably since the two parts are not connected to each other by a cable but by WiFi. The tablet is already configured to use only the TotalZap program and **must** remain **unconnected to internet** to avoid any unnecessary update issues or viruses.

It **must** also remain **permanently plugged to the 120V at all times** using the included USB cable and AC adapter so that the battery is always 100%. It is important to always keep the tablet connected with its adapter, it is a device that consumes almost nothing anyway.

0.2 Installation

After unpacking and thoroughly inspecting the condition of the products, allow the tablet to warm up and lose moisture if it is cold, it may take a few hours. Then you can start to install each part. For simplicity, the device is divided into two parts: The **frequency generator** in a black box with a 9V AC adapter and a **tablet** with a 5V AC adapter in its box.

First connect the 9V AC adapter to the rear of the frequency generator and turn on the power, the red LED should light up. Next, connect the black and red wires to the colored jacks on the front of the unit. You can now connect the two tubular electrodes to the other end of each cable. The BNC connector on the right allows you to connect another accessory at the same time if necessary.

Now place the aluminum stand on the generator or next to it and place the tablet horizontally on it. Then, press and hold the power button on the tablet about 4-5 seconds or until the logo appears and release the button, then wait about 30 seconds for the full start of Android. Now connect the supplied white cable and the 5V AC adapter. This ignition procedure is performed only the first time when the tablet is completely off.

Now press the TZ4 icon in the center of the screen to start the program even if the screen is initially in vertical mode. For future uses, it's not necessary to turn off the tablet completely, but simply press the power button for a half second to put it to sleep and turn it on instantly.

NOTE: For the Teclast P80X tablet, do not use the Google search function located at the top of the screen, it does not give anything since the tablet is not connected to the Internet and may affect the proper functioning of TotalZap.

0.3 Configuration

After starting the program, you must be normally on the **Config** tab. Almost nothing to configure, this panel is mostly an information screen.

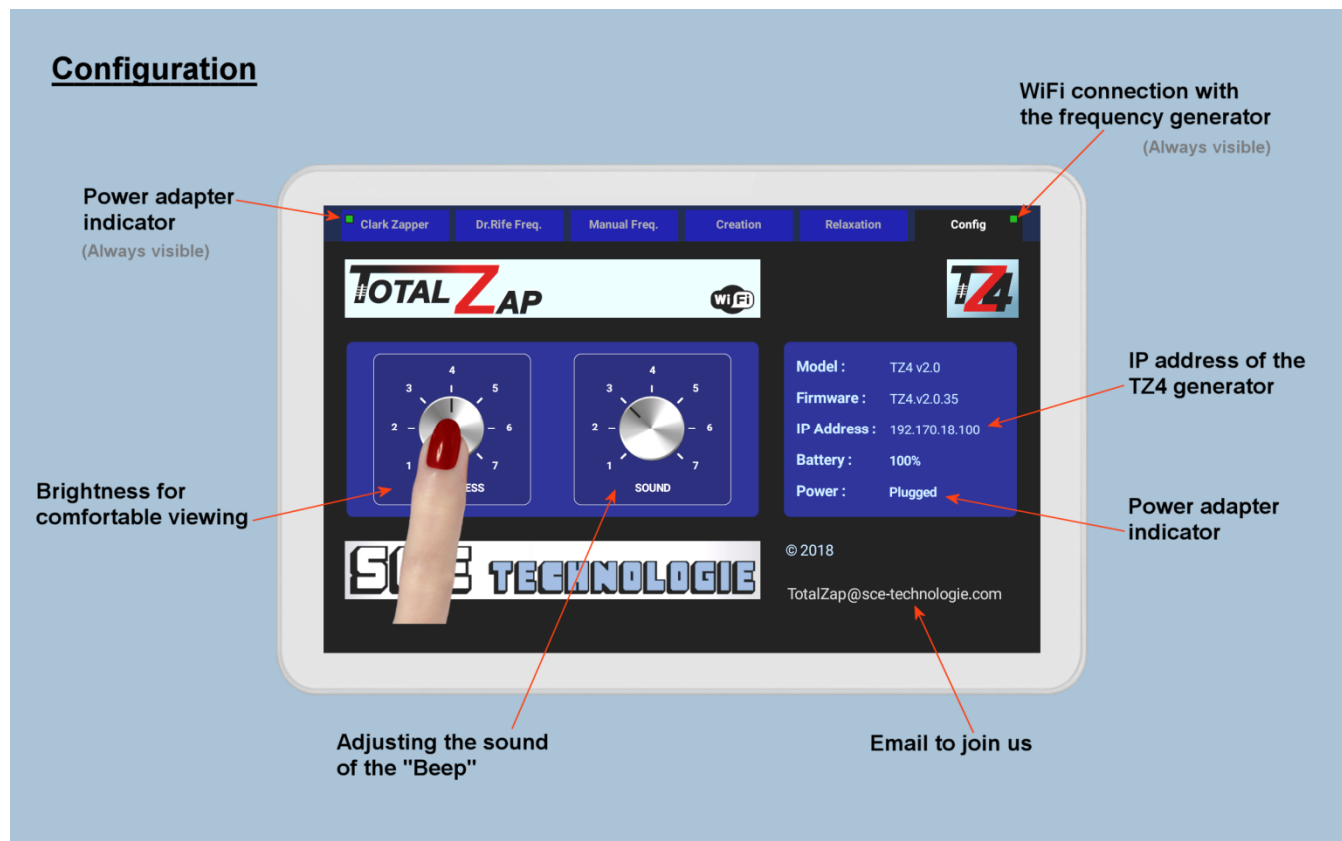

Only two very simple adjustments. The **BRIGHTNESS** button is used to adjust screen brightness for comfortable viewing in any circumstance and the **SOUND** button to the intensity of the "Beep" can be heard throughout the program to get our attention. To turn a knob, slide your finger in the bottom of the knob, it allows in this way a clear view of the pointer at same time.

The small square in the **right corner** indicates the status of the connection as follows:

Gray	: Search a connection
Red	: Not logged in
Yellow	: Connected to another system
Green	: Connected to the TotalZap frequency generator

When your connection goes green, you must also have this IP address: 192.170.18.xxx. This indicator is always visible for more convenience, even when you are in another screen.

The small square in the **left corner** indicates the status of the power adapter as follows:

Red : Not Plugged
Green : Tablet Plugged, all is OK

Next to the word **Power:** you can always see if the adapter is **plugged** or **unplugged** in addition to the small green indicator.

Next to the word **Battery:** now, the percentage of the battery is very clear. You can use the tablet for a few hours unplugged but avoid fall below 50%, the time will become longer for recharging. To recharge more quickly, turn off the tablet by pressing a quick tap on the Power button of the tablet (sleep mode), recharging will be done much faster.

NOTE: Sometimes it can take up to a minute for the connection to happen, due to WiFi interference in or around your home. If the connection has not been made after a minute, simply turn off and on the frequency generator to cause another connection request with the tablet.

1

TAB 1 - Dr. Hulda Clark Zapper

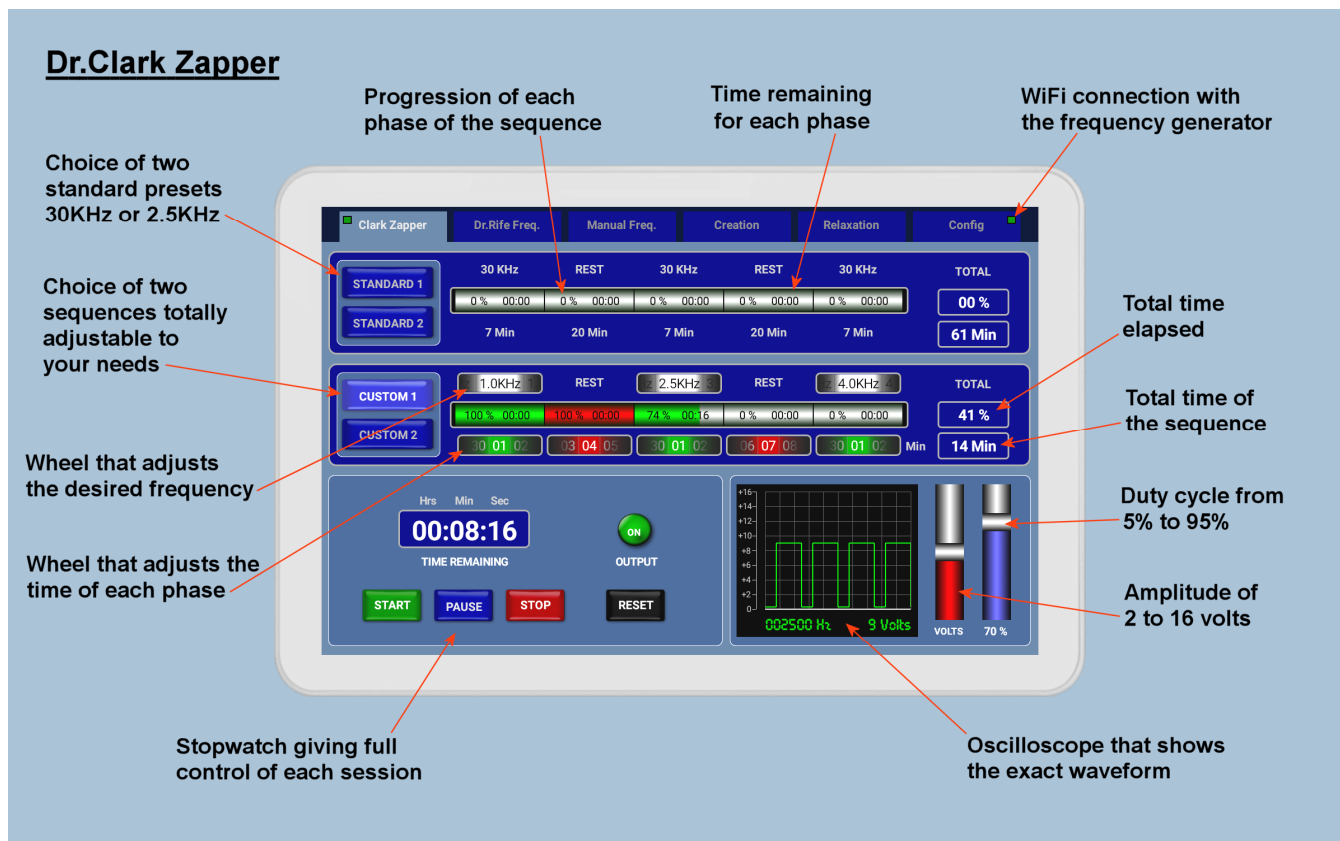

1.1 Fixed Sequences

The available sequences are divided into two panels: First panel contains the two sequences most popularized by Hulda Clark, **STANDARD 1** and **STANDARD 2** which are not modifiable. These sequences still have five phases, three active, two rest, as in his famous 7-20-7-20-7 sequence, 7 minutes of treatment and 20 minutes of rest.

1.2 Programmable Sequences

The second panel is fully editable to your needs. To program **CUSTOM 1** and **CUSTOM 2**, simply slide the adjustment wheels aside to change the frequencies and durations of each phase. Again, the sequence always five phases, three active and two of rest.

The total time is immediately displayed to the right to indicate how long your session will last. All choices in this section are automatically stored by the device. This section meets the frequency range specified by Hulda Clark, 1KHz to 50KHz and the time of each phase may vary from 1 to 30 minutes.

Since version 2.0, the remaining time has been added in each phase. This is useful if you want to do something else for a break, you know exactly how long the next phase will begin.

1.3 Stopwatch

The stopwatch allows you to follow in real time the progress of the session by indicating the percentage covered for each phase and the totality. Once the sequence is chosen, now you press **START** to start your session. The green LED will immediately light up on the frequency generator to indicate the presence of the output signal. During the course of a sequence, almost all buttons are disabled, only the **STOP** button can stop the sequence and take back the whole control. Then to reset everything, press the **RESET** button.

1.4 Oscilloscope

During sequence operation, the power (voltage) and duty cycle (ratio) settings are still active to get exactly the desired signal. These two sliders adjust the signal to a comfortable and efficient level.

Since Dr. Clark did not prescribe any treatment with a sinusoidal signal, only the square wave is available here, but it's the only panel that's like that.

2

TAB 2 - Dr. Royal Rife Frequency Generator

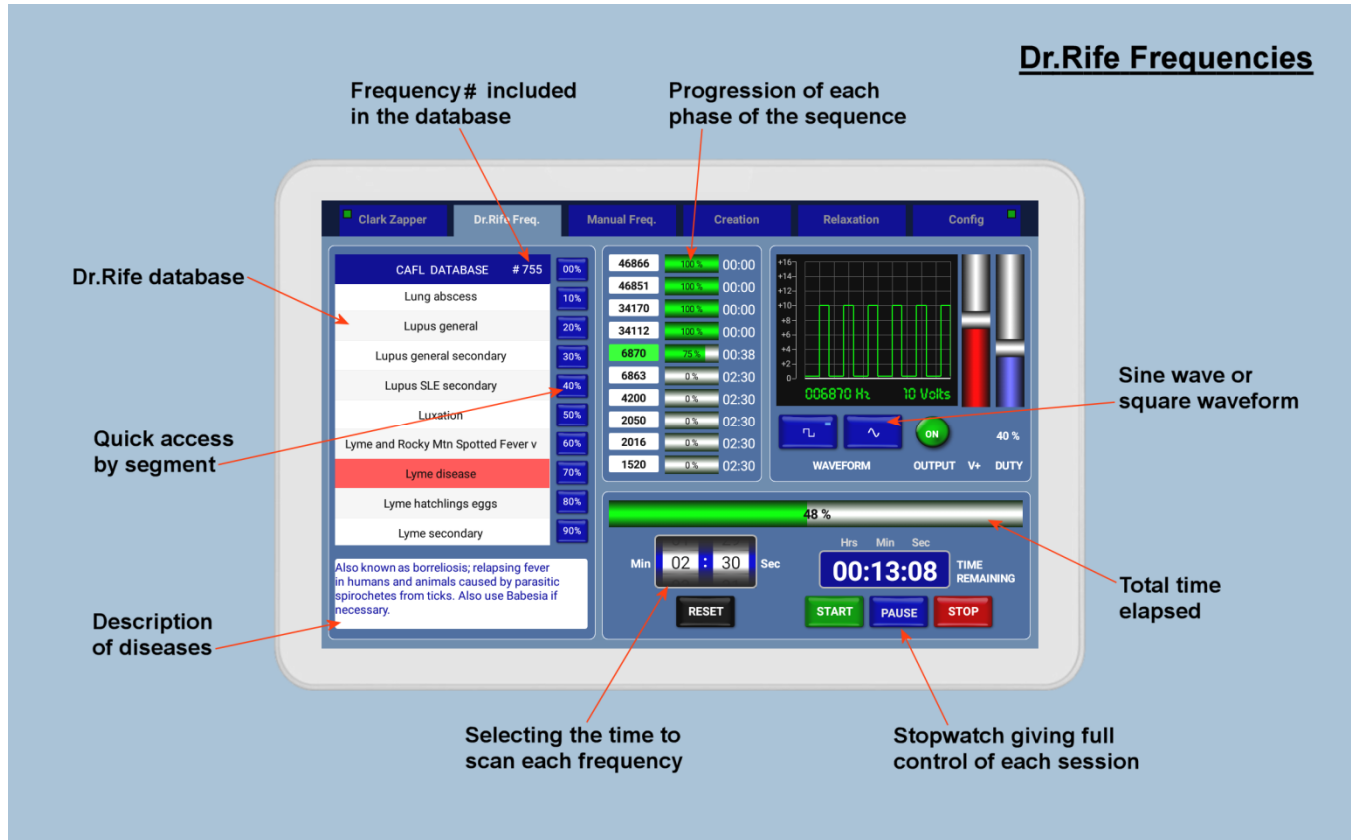

2.1 Database

This section is very different from the other, it offers not only four sequences but well over a thousand distributed in a database. The first panel on the left is this database arranged in alphabetical order. To select a line, just slide up and down list to rotate and hit a line. The bottom box allows you to see the description when it is provided. The side buttons allow you to make a quick jump in the list.

2.2 Frequencies

The central panel shows the frequencies associated with the selected line to a maximum of ten. Once the time has been selected by the stopwatch, you can start the sequence by pressing **START**. The system will scan each frequency one by one for the time that has been selected. Each line contains three elements: The frequency scanned in green, the progress bar in percent and the remaining time for each frequency in the sequence.

2.3 Stopwatch

As with the stopwatch Clark, it also allows you to monitor the real-time sequence, with an indication of the total percentage traveled on a very large progress bar. Once the sequence is chosen, choose a duration with the two wheels **Min** and **Sec** by scanning the numbers vertically. Then press **START**. The green LED will immediately light up on the frequency generator to indicate the presence of the signal on the output. Again, almost all buttons are deactivated during the sequence, only the **STOP** button to stop the sequence and resume full control. To reset everything, press the **RESET** button.

2.4 Oscilloscope

The oscilloscope is a wonderful instrument to see the shape of an electrical signal that is in principle invisible to our eye. On this device, it is the exact reflection of the output signal on frequency generator. For the waveform, it is possible to select a square or sine wave. In both cases the signal is positive, that is to say that the signal never goes below 0 volts and is maintained even higher with an offset of + 0.25V.

You have even more complete control of the output signal. The signal strength (amplitude) is fully adjustable between 2 and 16 volts in 1 volt step to adapt perfectly to your accessories and your sensitivity at different frequencies. The lower the frequency, the more we feel the current due to the natural impedance of our body.

Setting the duty cycle (ratio) is also very important to generate more harmonics and thus greatly increase the efficiency of the treatment. It is adjustable between 5% and 95% by 5% step.

3

TAB 3 - Manual Frequency Generator

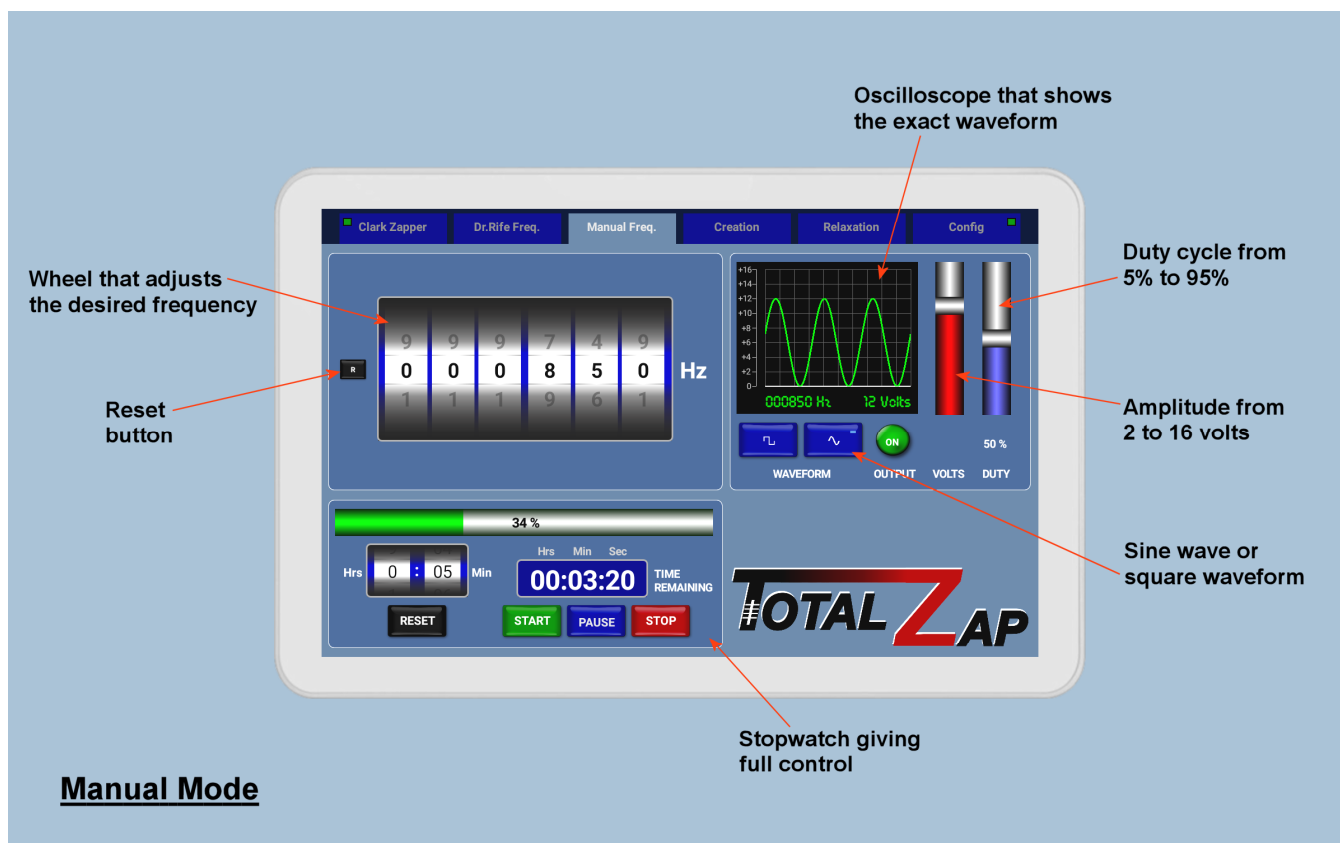

3.1 Frequency Selector

Despite its much simpler look, this section allows you to experiment everything you want. As for the other sections, the power and the duty cycle are totally adjustable but here in addition, we can choose the frequency between 1Hz and 999,999Hz square or sine wave with a step of 1Hz and the excellent accuracy of the DSP (Digital Signal Processor). Here, the big difference is the frequency selector with its very large easy-to-use wheels. A handy little **RESET** button is also available on the left of the selector, it resets the frequency to zero much faster.

3.2 Stopwatch

The stopwatch (new in v2.0), which can be up to **10 hours**, allows you to use this mode for a whole night. This mode can also be activated in continuous time to grow plants faster for example.

To do this, select no time (0:00) and press **START**, the frequency generator will be active continuously until you press **STOP**. This panel is the only one to run like that, all others need a selected time to activate their counter and the frequency generator.

4 TAB 4 - Creation

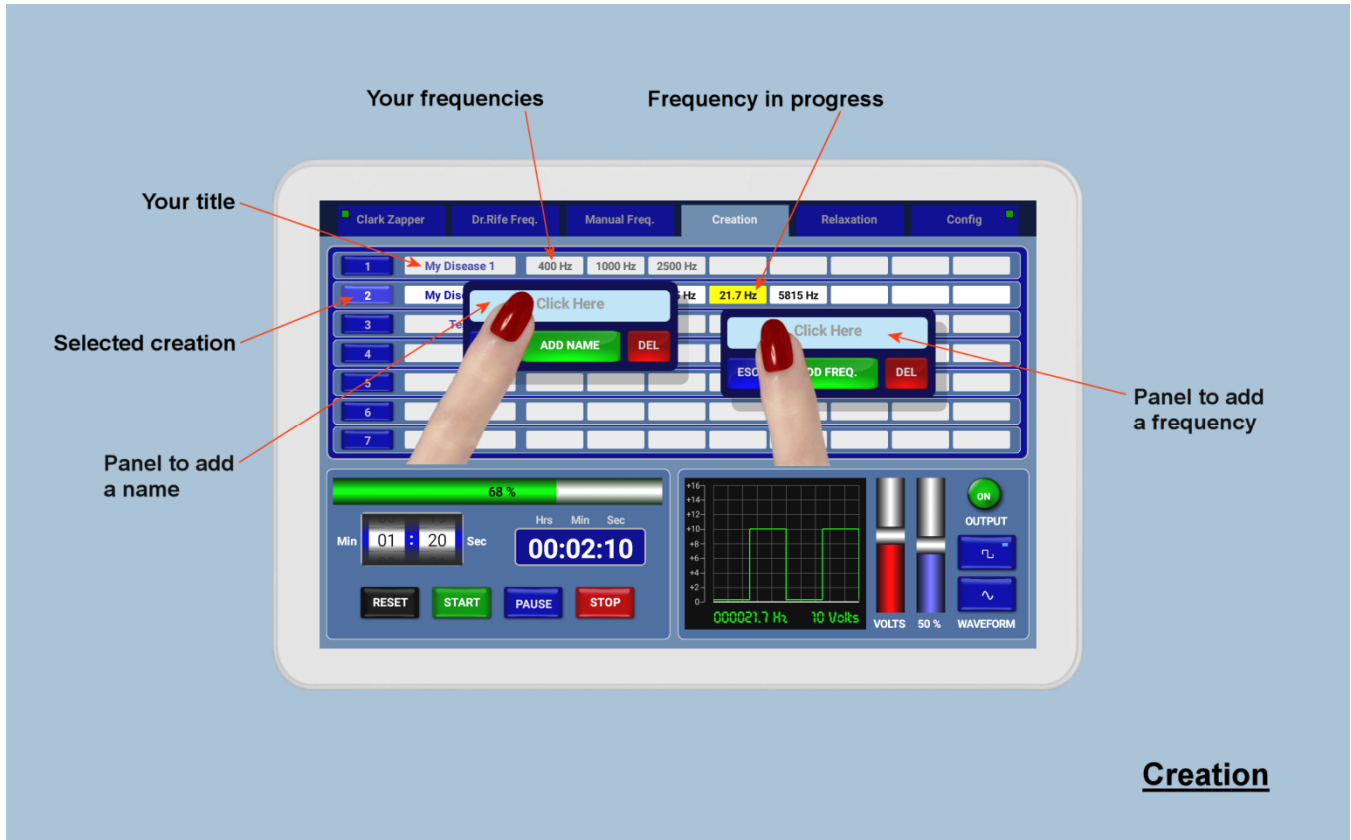

4.1 Create Yours

One of the great benefits of this device is this section, it is literally a Dr.Clark Zapper and a Dr.Rife custom machine. Simple and efficient! This screen allows you to enter a name and 8 frequencies for each of the 7 memorized choices. It is also possible to create a pause by leaving an empty frequency. Your choices are stored permanently but very easy to change at any time. No frequencies to program each time you turn on the device. Also no expensive cards to buy.

Of course, as in the other screens, you have a complete stopwatch and all the adjustment of the power and the waveform.

4.2 How to add a name

1 - The first action to take is to add a descriptive name to your choice. The maximum length of characters is 16. Press the first label you want to register the name, a small panel appears.

2 - Then, in the light blue rectangle, click on the inscription [Click Here](#), the keyboard of the tablet appears now.

3 - Enter the name of your choice. If you make a mistake about the name, you can erase it at once by pressing **DEL**. If you decide not to add or change the name, press **ESC** to cancel and exit this panel. If the name entered is perfect, press **ADD NAME** and the name will be written on the label.

4 - To erase a name: Press the label, the panel appears again. Then press **ADD NAME** without entering a name, the name of the label will disappear.

4.3 How to add a frequency

1 - To add a frequency, the procedure is quite similar except that this time the entry will be numeric only. Here the maximum number of characters is 6. Press the first label where you want to enter a frequency, another small panel appears.

2 - Then, in the light blue rectangle, click on the inscription [Click Here](#), this time it's a numeric keypad that appears.

3 - Enter the value of your frequency with 6 digits or decimals between 1 and 999999. Example: 123456, 12.45, 1234.6, 7.82 are all accepted. Keep in mind that the decimal point counts as one character too.

As for the panel of names, you can erase by pressing **DEL** and cancel with **ESC**. If the entered frequency is good, press **ADD FREQ.** and the number will be written on the label.

4 - To clear a frequency: press the label, the panel will reappear. Then press **ADD FREQ.** without entering anything, the number on the label will disappear.

5 - If you leave an empty frequency and this is not the last, the system will interpret it as a pause. This can be useful for creating sequences like those of Hulda Clark.

5

TAB 5 - Relaxation

Relaxation

Selection of 20 frequently used frequencies

Description for better understand each function

Pause example

Another interesting fact proven by experimentation! :-)

Frequency	Function
01	3.92 Hz Brain Tuner
02	4 Hz Relaxation
03	6.5 Hz Theta
04	7.83 Hz Schumann
05	10 Hz Dominant Alpha
06	11 Hz Concentration
07	15 Hz Inhibition of pain
08	20 Hz Energize
09	38 Hz Endorphin
10	111 Hz Beta Endorphin
11	304 Hz Headaches 1
12	432 Hz Sun sound
13	480 Hz Crown Chakra
14	520 Hz Headaches 2
15	528 Hz Heart Chakra
16	664 Hz Fatigue
17	727 Hz Cure-All 1
18	800 Hz Cure-All 2
19	880 Hz Decision
20	1000 Hz Food & Water

Stimulates your relaxation, allows brain to produce enkaphalins, all natural pain killer and reduce stress. Can also be used to increase plant growth.

000004 Hz 10 Volts

50%

22%

0 : 08 Min 00:06:18

RESET START PAUSE STOP

Another very popular group of frequencies are the extremely low frequencies. They are often used for their relaxing effect. Here 20 of the most common are listed in order with a description for each.

Extremely low frequencies (1Hz - 200Hz) are an excellent choice for:

- 4Hz Stimulates your relaxation, allows brain to produce enkaphalins, all natural pain killer and reduce stress
- 7.83Hz Frequency of Schumann which gives a calming and reassuring effect, which connects us to the Earth
- 10Hz Stimulation of serotonin and norepinephrine
- 11Hz Stimulates Alpha waves in the brain, good for studying and also helps to relax
- 15Hz Inhibition of chronic pain, normalization of blood pressure, stimulation of the lymphatic circulation
- 111Hz Stimulates Beta-Endorphin

Other frequently used frequencies:

- 528Hz DNA repair
- 727Hz For detox. Commonly used "cure-all" Rife Frequency
- 1KHz Purification of food and water
- Several to increase your immune system...

6 Other

6.1 Total Security

For a device to be used by a person, it is essential that its security is 100%. Here, everything has been designed to achieve this level of security without making any compromises.

This device contains no less than 6 protections for your safety. From the power supply to the output, everything has been implemented to eliminate any risk. For 100% protection, it is recommended to use the ground (green) terminal on the back of the frequency generator. You can use a standard 4mm banana plug or just a wire by unscrewing the terminal. The other side of the wire must be grounded in your home with an electrical outlet or your plumbing.

Each unit is rigorously inspected on an oscilloscope and passes an insulation test before shipping. This product is designed and manufactured in Canada.

6.2 Disclaimer

This product has not been licensed as a medical device, it may be used as an experimental device only for individual or educational research. **The use of this device is at your own risk.**

If you are **pregnant** or if you are wearing an electronic **pacemaker**, **do not use it.**

6.3 Warranty

A one-year warranty covers all repairs or replacements for normal use. Each assumes the cost of shipping to send the product.

6.4 Contact Us

All emails will be replied within 24 hours. Do not hesitate to contact us for any questions or comments concerning our products or your need.

TotalZap@sce-technologie.com

7 Technical Data

Frequency Range	1Hz - 1MHz
Frequency Resolution	1Hz
Frequency Accuracy	0.01%
Time accuracy	0.001 sec.
Amplitude Range	2V - 16V (peak to peak)
Amplitude Resolution	1V Steps
Output Waveforms	Square and Sine
Duty Cycle (Ratio)	5% - 95%
Positive DC Offset	+0.25V
Output Impedance	1K ohms
Output Current	3.5mA max.
Processor & DSP	240MHz & 125MHz Cristal Controlled
Communication	WiFi 802.11 b / g / n
Display / Controller	Color 8" High Resolution 1.3GHz Quad Core Tablet
Tubular Electrodes	2 Stainless 316 tubes 175mm x 22mm (7" x 7/8") with all connectors gold plated
Power Supply	120 to 9VDC 1A Adapter CE / UL Certified
Protections	1 - Automatic Resettable Fuse (PTC) 2 - Bridge Diodes Isolation 3 - Reverse Polarity Protection 4 - Ground Access Binding Post 5 - Output Short-Circuit Protection 6 - Output 1K ohms Current Limiting