

TotalZap TZ4

User Manual



Version 3.5

SCE Technologie © 2022

Infos and Price? www.sce-technologie.com

Questions? TotalZap@sce-technologie.com

Contents

0	Introduction	1
0.1	The Concept	1
0.2	Installation	1
0.3	Configuration	2
1	TAB 1 - Dr. Hulda Clark Zapper	4
1.1	Fixed Sequences	4
1.2	Programmable Sequences	4
1.3	Stopwatch	5
1.4	Oscilloscope	5
2	TAB 2 - Dr. Royal Rife Frequency Generator	6
2.1	Database	6
2.2	Frequencies	7
2.3	Stopwatch	7
2.4	Oscilloscope	7
3	TAB 3 - Manual Frequency Generator	8
3.1	Frequency Selector	8
3.2	Stopwatch	8
3.3	Sound	9
4	TAB 4 - Creation	10
4.1	Create Your Own Frequency Programs	10
4.2	How to add a name	11
4.3	How to add a frequency	11
5	TAB 5 - Relaxation	12
6	TAB 6 - Relaxing Videos	13
6.1	Complete relaxation	13
6.2	How to play a video	13
6.3	The video remote control	14
7	TAB 7 - Color Strobe	15
7.1	Its usefulness	15
7.2	How it works	15
7.3	The strobe remote control	16

8	Other	17
8.1	Total Security	17
8.2	Disclaimer	17
8.3	Warranty	17
8.4	Contact Us	17
9	Technical Data	18

0 Introduction

0.1 The Concept

First of all, thank you very much for choosing our system. We hope that it will provide you with exceptional service for many years and will fully meet your expectations.

This system is basically a closed WiFi mini-network consisting of an Android tablet and a dedicated frequency generator with inside a WiFi transmitter in "Access Point" mode, that is to say, it acts as a router. The distance between the two can vary considerably since the two parts are not connected to each other by a cable but by WiFi. The tablet is already configured to use only the TotalZap program and **must** remain **unconnected to internet** to avoid any unnecessary update issues or viruses.

It **must** also remain **permanently plugged to the wall at all times** using the included USB cable and AC adapter so that the battery is always 100%. It is important to always keep the tablet connected with its adapter, it is a device that consumes almost nothing anyway.

0.2 Installation

After unpacking and thoroughly inspecting the condition of the products, allow the tablet to warm up and lose moisture if it is cold, it may take a few hours. Then you can start to install each part. For simplicity, the device is divided into two parts: The **frequency generator** in a black box with a 9V AC adapter and a **tablet** with a 5V AC adapter in its box.

First connect the 9V AC adapter to the rear of the frequency generator and turn on the power, the red LED should light up. Then connect the black and red wires to the colored sockets on the front of the unit. You can now connect the accessories at the ends of each cable.

Now place the holder next to the generator and place the tablet horizontally on it. Next, press and hold the power button on the tablet for 5 seconds and release the button, then wait about 30 seconds for Android to fully start up. Now plug in the supplied white cable and the 5V power adapter. This startup procedure is only performed the first time when the tablet is completely turned off.

Now press the TZ4 icon in the center of the screen to start the program even if the screen is initially in vertical mode. For future uses, it's not necessary to turn off the tablet completely, but simply press the power button for a half second to put it to sleep and turn it on instantly.

NOTE: When you turn ON the frequency generator, the WiFi connection usually takes 5-30 seconds, but sometimes the connection may take up to a minute, due to WiFi interference in or around your house. If the connection has not been established after one minute, leave the generator ON and restart the tablet by pressing the "POWER" button on the tablet for 3 seconds and "Restart" and "Ok". Once the connection is established, you can leave the generator always ON to avoid this wait.

0.3 Configuration

After starting the program, you must be normally on the **Config** tab. Almost nothing to configure, this panel is mostly an information screen.

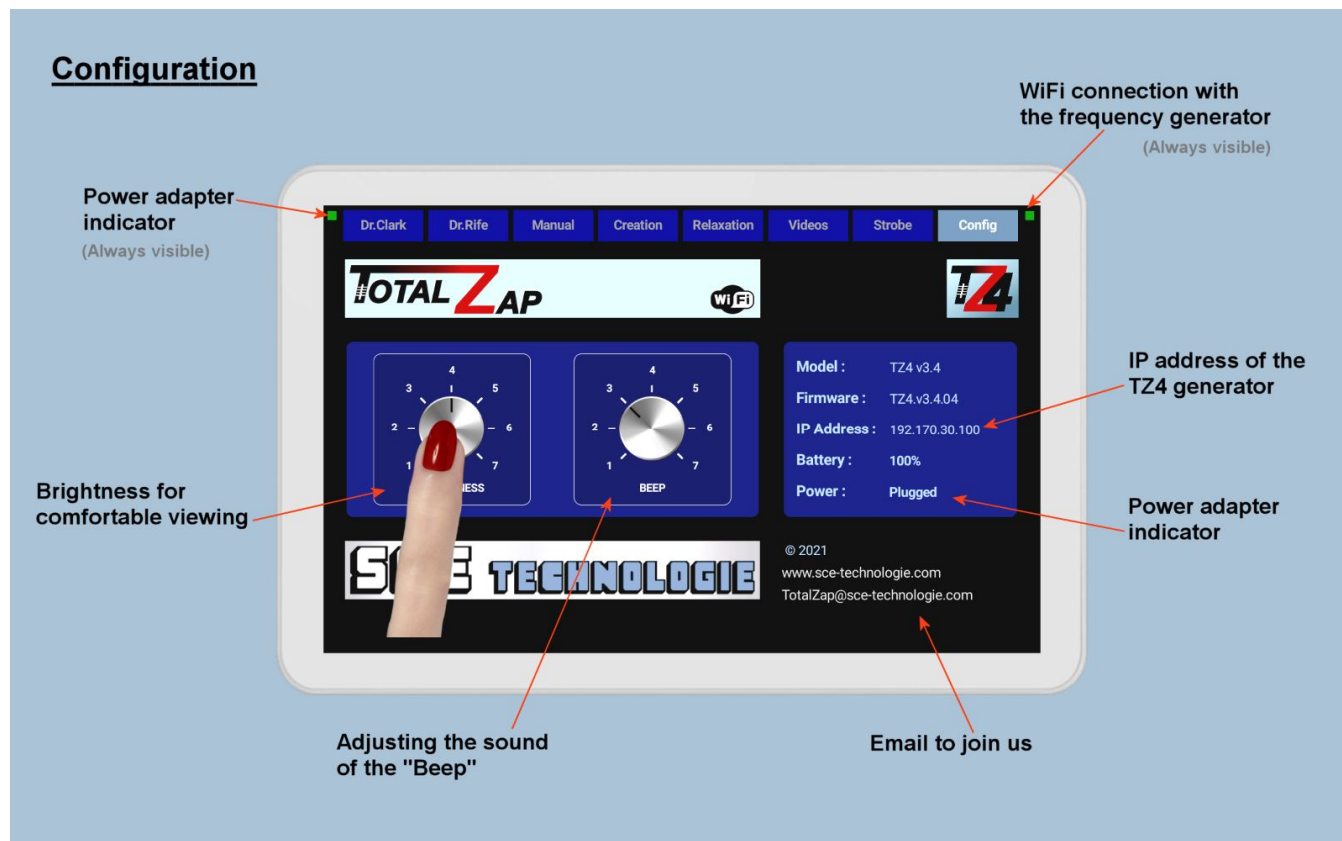

Only two very simple adjustments. The **BRIGHTNESS** button is used to adjust screen brightness for comfortable viewing in any circumstance and the **BEEP** button to the intensity of the "Beep" can be heard throughout the program to get our attention. To turn a knob, slide your finger in the bottom of the knob, it allows in this way a clear view of the pointer at same time.

The small square in the **right corner** indicates the status of the connection as follows:

Gray	: Search a connection
Red	: Not connected
Yellow	: Connected to another system (Often the home router)
Green	: Connected to the TotalZap frequency generator

When your connection goes green, you must have address: **192.170.30.xxx**. This indicator is always visible for more convenience, even when you are in another screen.

The small square in the **left corner** indicates the status of the power adapter as follows:

Red : Not Plugged
Green : Tablet Plugged, all is OK

Next to the word **Power:** you can always see if the adapter is **plugged** or **unplugged** in addition to the small green indicator.

Next to the word **Battery:** now, the percentage of the battery is very clear. You can use the tablet for a few hours unplugged but avoid fall below 50%, the time will become longer for recharging. To recharge more quickly, turn off the screen by pressing a quick tap on the Power button of the tablet (sleep mode), recharging will be done much faster.

1

TAB 1 - Dr. Hulda Clark Zapper

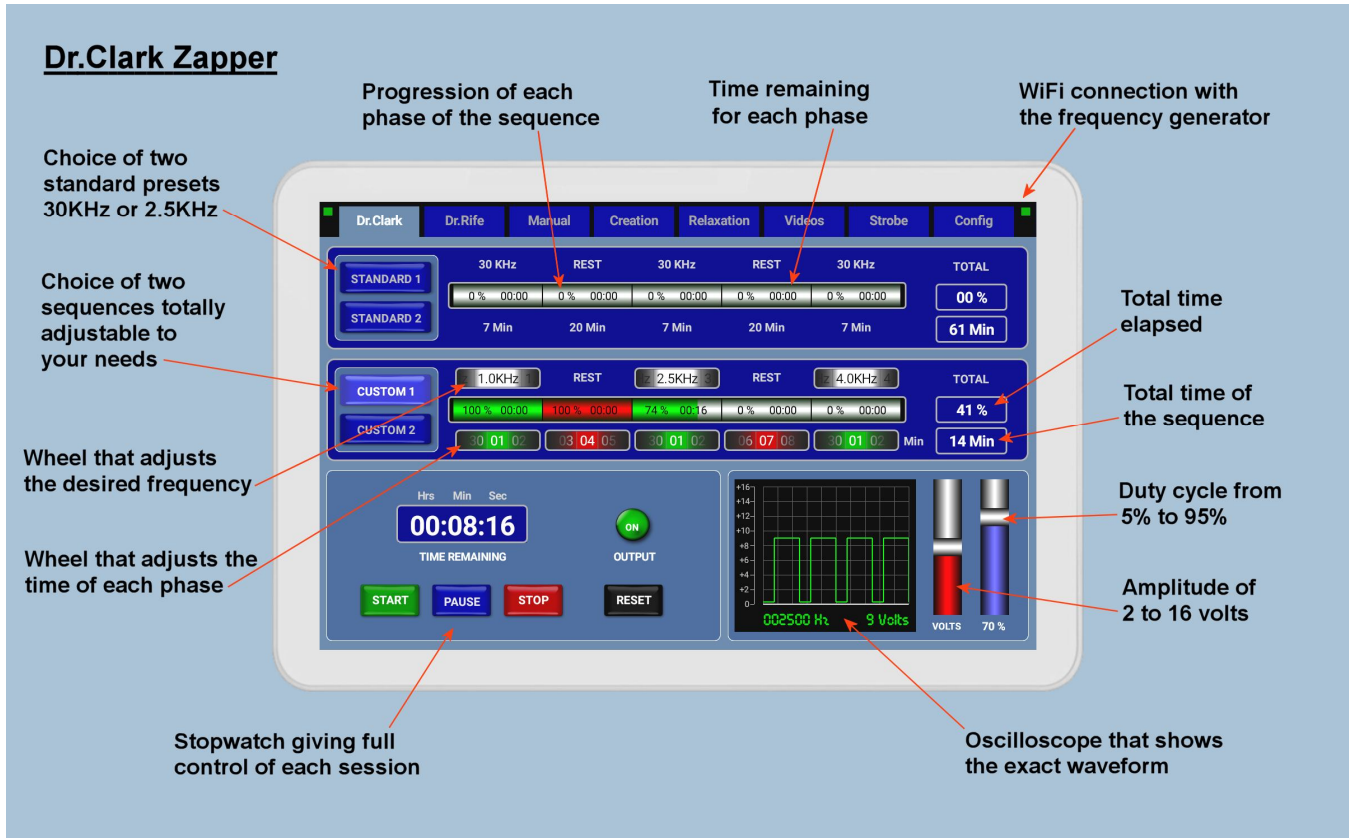

1.1 Fixed Sequences

The available sequences are divided into two panels: First panel contains the two sequences most popularized by Hulda Clark, **STANDARD 1** and **STANDARD 2** which are not modifiable. These sequences still have five phases, three active, two rest, as in his famous 7-20-7-20-7 sequence, 7 minutes of treatment and 20 minutes of rest.

1.2 Programmable Sequences

The second panel is fully editable to your needs. To program **CUSTOM 1** and **CUSTOM 2**, simply slide the adjustment wheels aside to change the frequencies and durations of each phase. Again, the sequence always five phases, three active and two of rest.

The total time is immediately displayed to the right to indicate how long your session will last. All choices in this section are automatically stored by the device. This section meets the frequency range specified by Hulda Clark, 1KHz to 50KHz and the time of each phase may vary from 1 to 30 minutes.

Since version 2.0, the remaining time has been added in each phase. This is useful if you want to do something else for a break, you know exactly how long the next phase will begin.

1.3 Stopwatch

The stopwatch allows you to follow in real time the progress of the session by indicating the percentage covered for each phase and the totality. Once the sequence is chosen, now you press **START** to start your session. The green LED will immediately light up on the frequency generator to indicate the presence of the output signal. During the course of a sequence, almost all buttons are disabled, only the **STOP** button can stop the sequence and take back the whole control. Then to reset everything, press the **RESET** button.

1.4 Oscilloscope

During sequence operation, the power (voltage) and duty cycle (ratio) settings are still active to get exactly the desired signal. These two sliders adjust the signal to a comfortable and efficient level.

Since Dr. Clark did not prescribe any treatment with a sinusoidal signal, only the square wave is available here, but it's the only panel that's like that.

2

TAB 2 - Dr. Royal Rife Frequency Generator

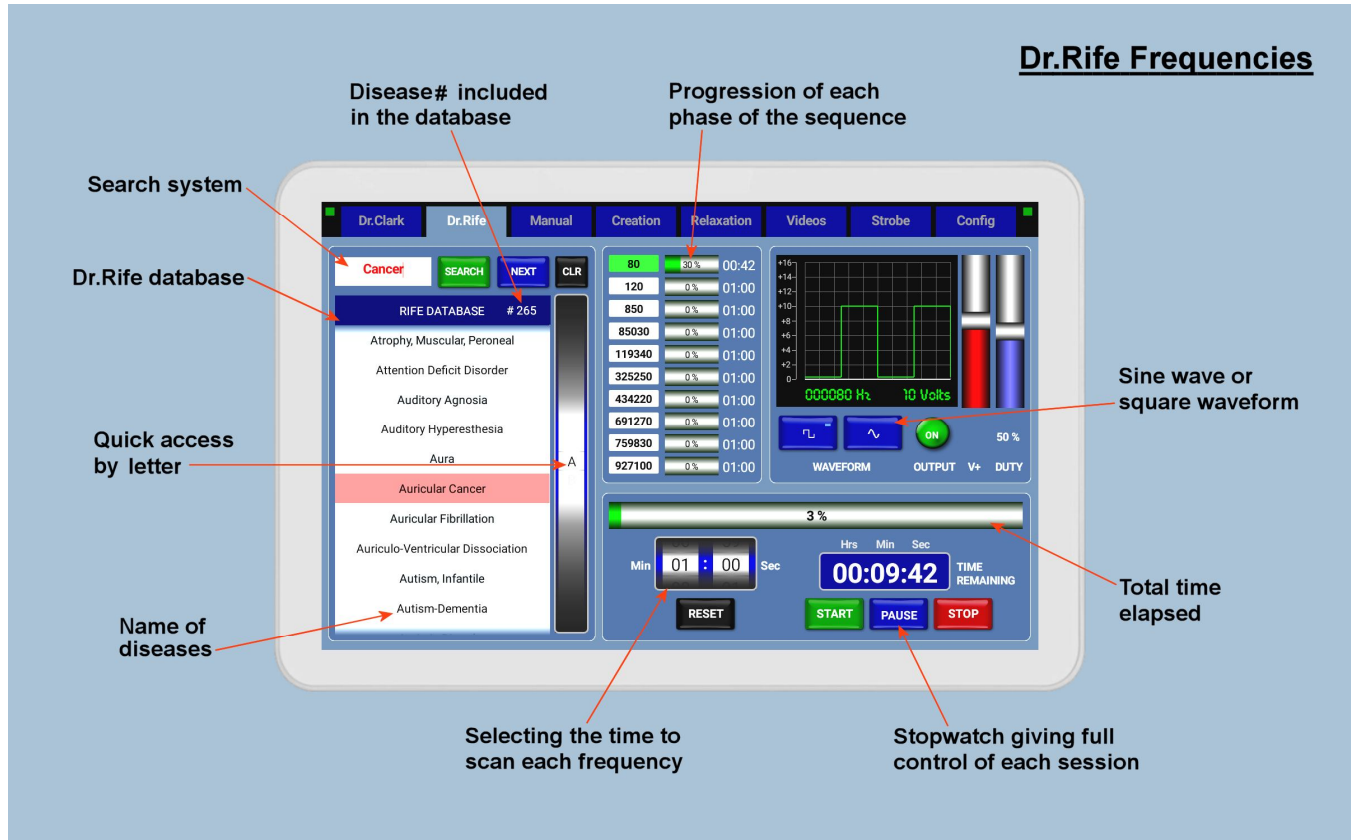

2.1 Database

This section is very different from the other one, it proposes not only four sequences but rather several thousands distributed in a database. The first panel on the left is this database classified in alphabetical order. To select a line, simply drag the list up and down to rotate it and reach a line. The side wheel allows you to jump faster through the list by moving forward by each letter.

A second method is also proposed at the top of this list by a search system. Simply enter a word or part of a word in the blank input field using the keyboard. Then press **SEARCH** and the system will jump directly to the corresponding place. If there are other matches further down the list, the **NEXT** button turns blue and can be used to go to the next ones. When this button turns gray again, there is no further match. The **CLR** button is simply used to clear the search field before making a new search.

2.2 Frequencies

The central panel shows the frequencies associated with the selected line to a maximum of ten. Once the time has been selected by the stopwatch, you can start the sequence by pressing **START**. The system will scan each frequency one by one for the time that has been selected. Each line contains three elements: The frequency scanned in green, the progress bar in percent and the remaining time for each frequency in the sequence.

2.3 Stopwatch

As with the stopwatch Dr.Clark, it also allows you to monitor the real-time sequence, with an indication of the total percentage traveled on a very large progress bar. Once the sequence is chosen, choose a duration with the two wheels **Min** and **Sec** by scanning the numbers vertically. Then press **START**. The green LED will immediately light up on the frequency generator to indicate the presence of the signal on the output. Again, almost all buttons are deactivated during the sequence, only the **STOP** button to stop the sequence and resume full control. To reset everything, press the **RESET** button.

2.4 Oscilloscope

The oscilloscope is a wonderful instrument to see the shape of an electrical signal that is in principle invisible to our eye. On this device, it is the exact reflection of the output signal on frequency generator. For the waveform, it is possible to select a square or sine wave. In both cases the signal is positive, that is to say that the signal never goes below 0 volts and is maintained even higher with an offset of + 0.25V as prescribed by Hulda Clark.

You have even more complete control of the output signal. The signal strength (amplitude) is fully adjustable between 2 and 16 volts in 1 volt step to adapt perfectly to your accessories and your sensitivity at different frequencies. The lower the frequency, the more we feel the current due to the natural impedance of our body.

Setting the duty cycle (ratio) is also very important to generate more harmonics and thus greatly increase the efficiency of the treatment. It is adjustable between 5% and 95% by 5% step.

3

TAB 3 - Manual Frequency Generator

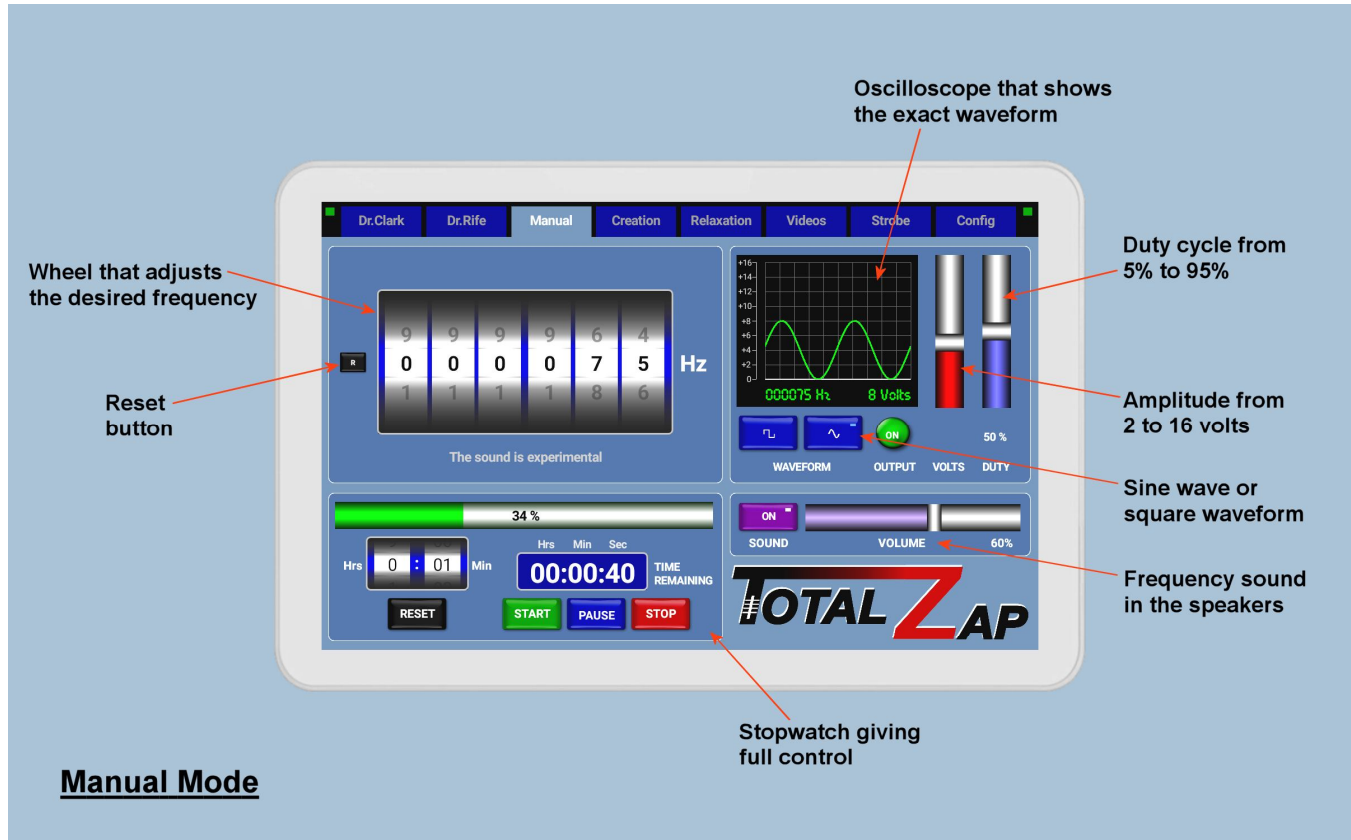

3.1 Frequency Selector

Despite its much simpler look, this section allows you to experiment everything you want. As for the other sections, the power and the duty cycle are totally adjustable but here in addition, we can choose the frequency between 1Hz and 999,999Hz square or sine wave with a step of 1Hz and the excellent accuracy of the DSP (Digital Signal Processor). Here, the big difference is the frequency selector with its very large easy-to-use wheels. A handy little **RESET** button is also available on the left of the selector, it resets the frequency to zero much faster.

3.2 Stopwatch

The stopwatch, which can be up to **10 hours**, allows you to use this mode for a whole night. This mode can also be activated in continuous time to grow plants faster for example.

To do this, select no time (0:00) and press **START**, the frequency generator will be active continuously until you press **STOP**. This panel is the only one to run like that, all others need a selected time to activate their counter and the frequency generator.

3.3 Sound

Here in addition to generating a frequency on the electrodes for a precise treatment, it is also possible to listen to the frequency through the tablet speakers or headsets. Simply generate a frequency and press the **SOUND** button. The volume next to it allows you to dose the power and its position is stored in memory.

Note: This section is still experimental and its performance may vary from one tablet model to another.

4 TAB 4 - Creation

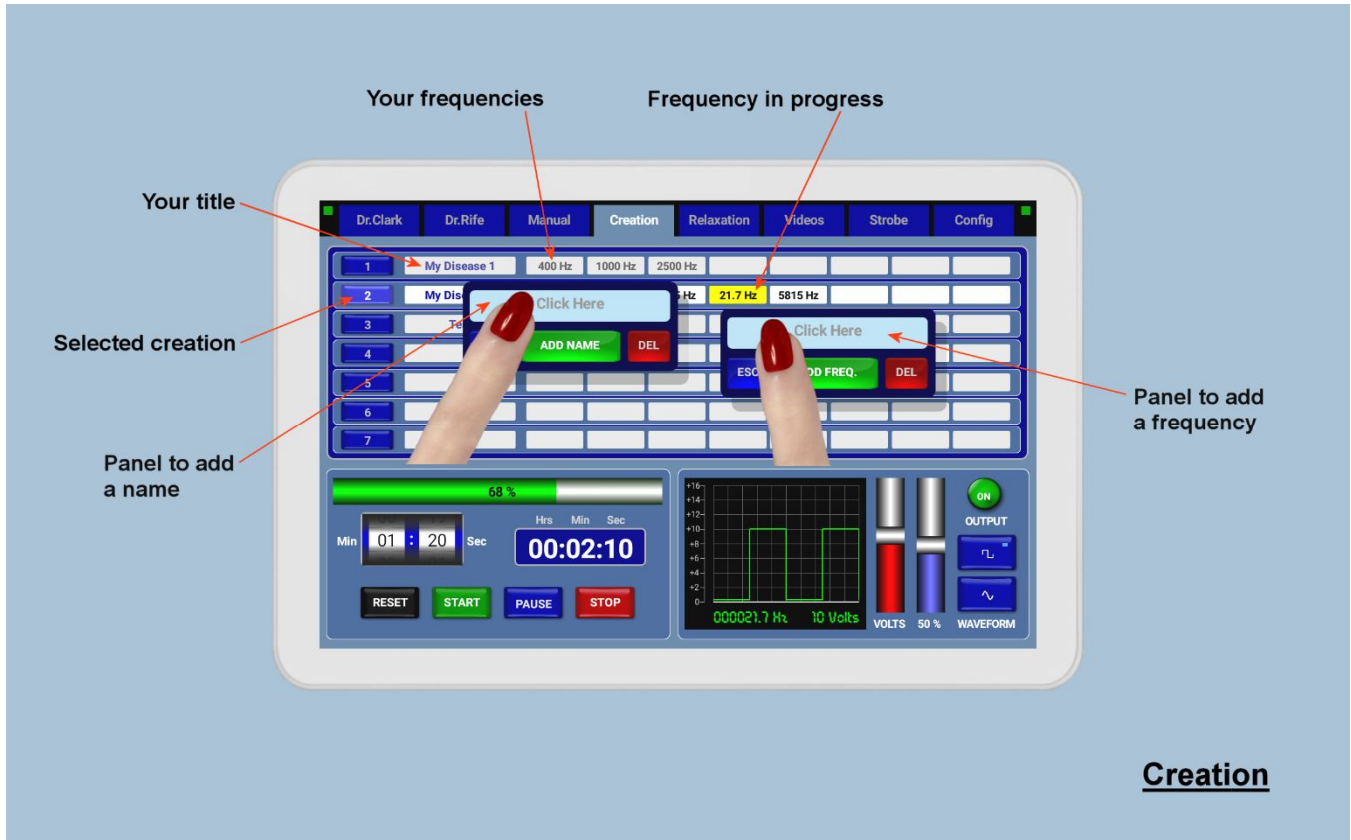

4.1 Create Your Own Frequency Programs

One of the great benefits of this device is this section, it is literally a Dr.Clark Zapper and a Dr.Rife custom machine. Simple and efficient! This screen allows you to enter a name and 8 frequencies for each of the 7 memorized choices. It is also possible to create a pause by leaving an empty frequency. Your choices are stored permanently but very easy to change at any time. No frequencies to program each time you turn on the device. Also no expensive cards to buy.

Of course, as in the other screens, you have a complete stopwatch and all the adjustment of the power and the waveform.

4.2 How to add a name

1 - The first action to take is to add a descriptive name to your choice. The maximum length of characters is 16. Press the first label you want to register the name, a small panel appears.

2 - Then, in the light blue rectangle, click on the inscription [Click Here](#), the keyboard of the tablet appears now.

3 - Enter the name of your choice. If you make a mistake about the name, you can erase it at once by pressing **DEL**. If you decide not to add or change the name, press **ESC** to cancel and exit this panel. If the name entered is perfect, press **ADD NAME** and the name will be written on the label.

4 - **To erase a name:** Press the label, the panel appears again. Then press **ADD NAME** without entering a name, the name of the label will disappear.

4.3 How to add a frequency

1 - To add a frequency, the procedure is quite similar except that this time the entry will be numeric only. Here the maximum number of characters is 6. Press the first label where you want to enter a frequency, another small panel appears.

2 - Then, in the light blue rectangle, click on the inscription [Click Here](#), this time it's a numeric keypad that appears.

3 - Enter the value of your frequency with 6 digits or decimals between 1 and 999999. Example: 123456, 12.45, 1234.6, 7.82 are all accepted. Keep in mind that the decimal point counts as one character too.

As for the panel of names, you can erase by pressing **DEL** and cancel with **ESC**. If the entered frequency is good, press **ADD FREQ.** and the number will be written on the label.

4 - **To clear a frequency:** press the label, the panel will reappear. Then press **ADD FREQ.** without entering anything, the number on the label will disappear.

5 - If you leave an empty frequency and this is not the last, the system will interpret it as a pause. This can be useful for creating sequences like those of Hulda Clark.

5

TAB 5 - Relaxation

Relaxation

Selection of 20 frequently used frequencies

Description for better understand each function

Another interesting fact proven by experimentation! :-)

Pause example

The screenshot shows a software interface for selecting relaxation frequencies. It features a menu bar with options like 'Dr.Clark', 'Dr.Rife', 'Manual', 'Creation', 'Relaxation', 'Videos', 'Strobe', and 'Config'. Below the menu, there are two columns of frequency buttons, each with a number, frequency, and name. A description box at the bottom left explains the effects of the selected frequency. On the right, there is a waveform display, a volume knob, and a 'Pause' button. A progress bar and a timer are also visible.

Frequency (Hz)	Function/Name
01	3.92 Hz Brain Tuner
02	4 Hz Relaxation
03	6.5 Hz Theta
04	7.83 Hz Schumann
05	10 Hz Dominant Alpha
06	11 Hz Concentration
07	15 Hz Inhibition of pain
08	20 Hz Energize
09	38 Hz Endorphin
10	111 Hz Beta Endorphin
11	304 Hz Headaches 1
12	432 Hz Sun sound
13	480 Hz Crown Chakra
14	520 Hz Headaches 2
15	528 Hz Heart Chakra
16	664 Hz Fatigue
17	727 Hz Cure-All 1
18	800 Hz Cure-All 2
19	880 Hz Decision
20	1000 Hz Food & Water

Stimulates your relaxation, allows brain to produce enkaphalins, all natural pain killer and reduce stress. Can also be used to increase plant growth.

000004 Hz 10 Volts

50%

22%

Hrs 0 : 08 Min 00:06:18

RESET START PAUSE STOP

Another very popular group of frequencies are the extremely low frequencies. They are often used for their relaxing effect. Here 20 of the most common are listed in order with a description for each.

Extremely low frequencies (1Hz - 200Hz) are an excellent choice for:

- 4Hz Stimulates your relaxation, allows brain to produce enkaphalins, all natural pain killer and reduce stress
- 7.83Hz Frequency of Schumann which gives a calming and reassuring effect, which connects us to the Earth
- 10Hz Stimulation of serotonin and norepinephrine
- 11Hz Stimulates Alpha waves in the brain, good for studying and also helps to relax
- 15Hz Inhibition of chronic pain, normalization of blood pressure, stimulation of the lymphatic circulation
- 111Hz Stimulates Beta-Endorphin

Other frequently used frequencies:

- 528Hz DNA repair
- 727Hz For detox. Commonly used "cure-all" Rife Frequency
- 1KHz Purification of food and water
- Several to increase your immune system...

6

TAB 6 - Relaxing Videos

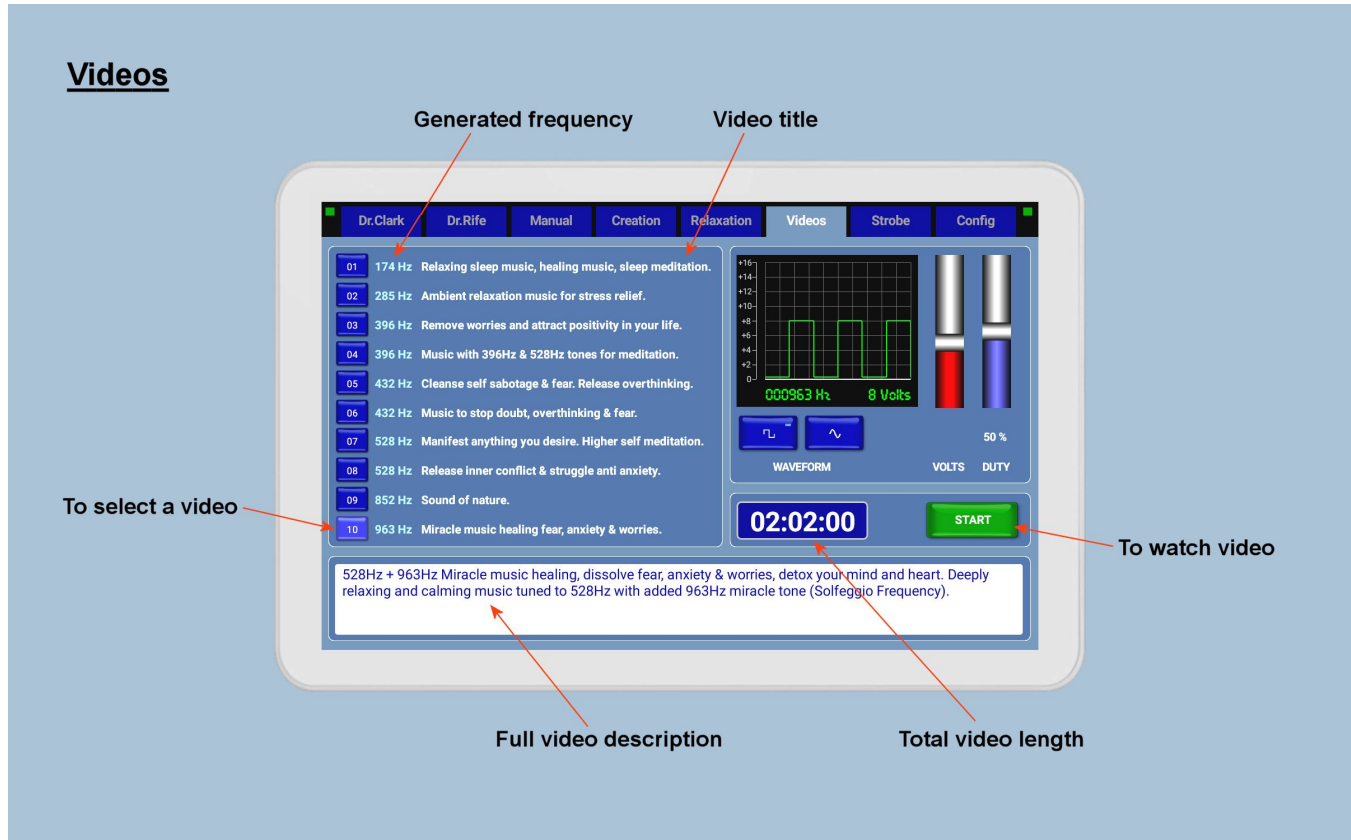

6.1 Complete relaxation

Here the device becomes a multi-media center in addition to being an electrotherapy device at the same time. It allows you to relax on a relaxing video and listen to appeasing music. At the same time, it allows a treatment on the electrodes with the frequencies that correspond to the chakras introduced in each video. This is called the "Solfeggio Frequencies".

6.2 How to play a video

To select a video, simply press one of the 10 buttons on the left. A description will be displayed in the bottom space and its total duration next to the **START** button. At the same time, its frequency will be entered into the oscilloscope. You must make adjustments before starting the video. Then press the **START** button.

6.3 The video remote control

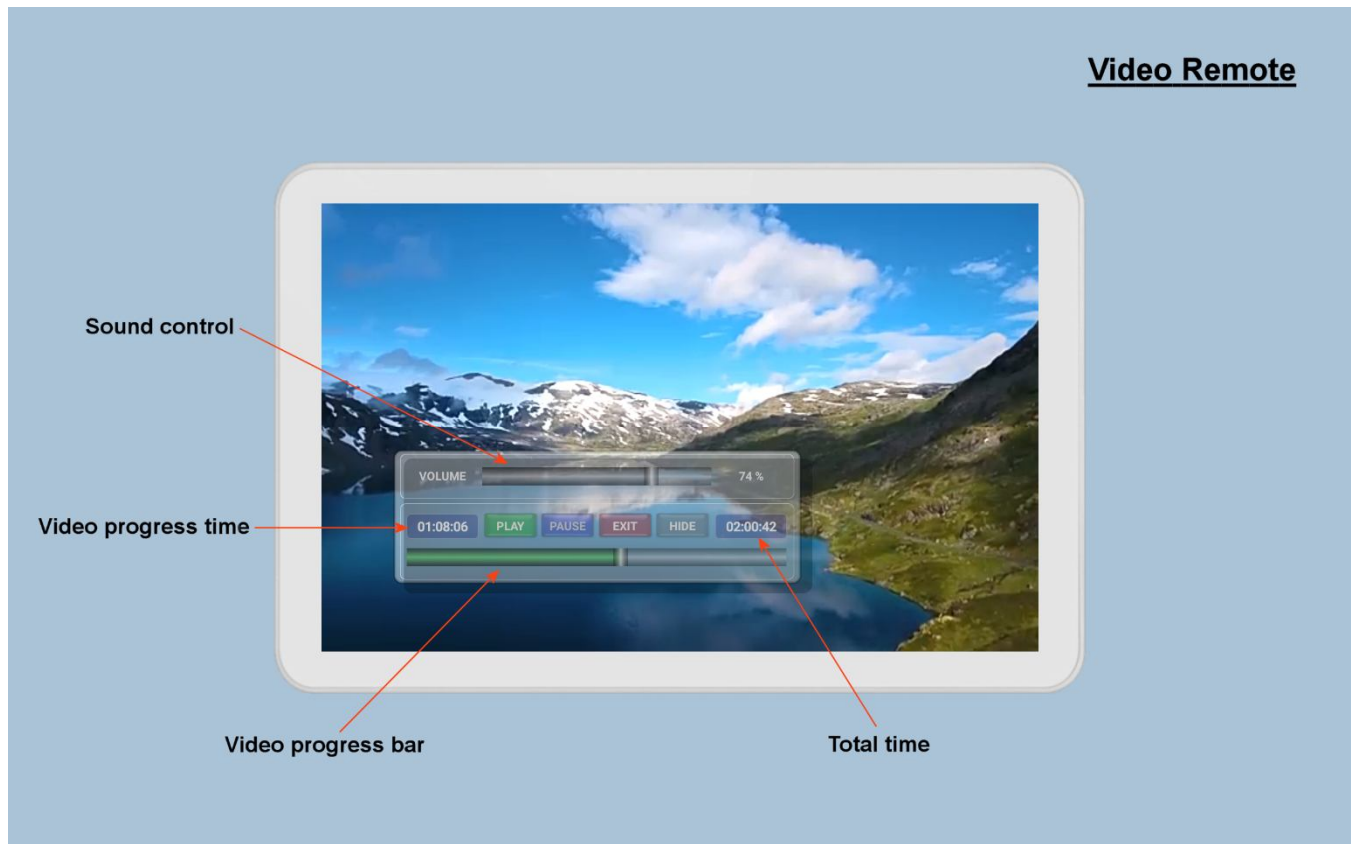

While the video is playing, press anywhere on the screen to bring up the remote control. It is translucent to better see the video at the same time.

A volume bar is available at the top and its position is always stored in the tablet. The other bar at the bottom, the progress bar, allows you to view the progress of the video but also to move inside by dragging the cursor.

The display on the left shows the time you are in the video while the display on the right shows the total duration. The 4 buttons are simple and intuitive: **PAUSE** temporarily stops the video, the signal on the frequency generator is also paused. The **PLAY** button allows to continue and reactivate the signal on the electrodes. The **HIDE** button only makes the remote control disappear without any further action. And the last one, the **EXIT** button allows you to exit the video completely and return to the selection screen.

7

TAB 7 - Color Strobe

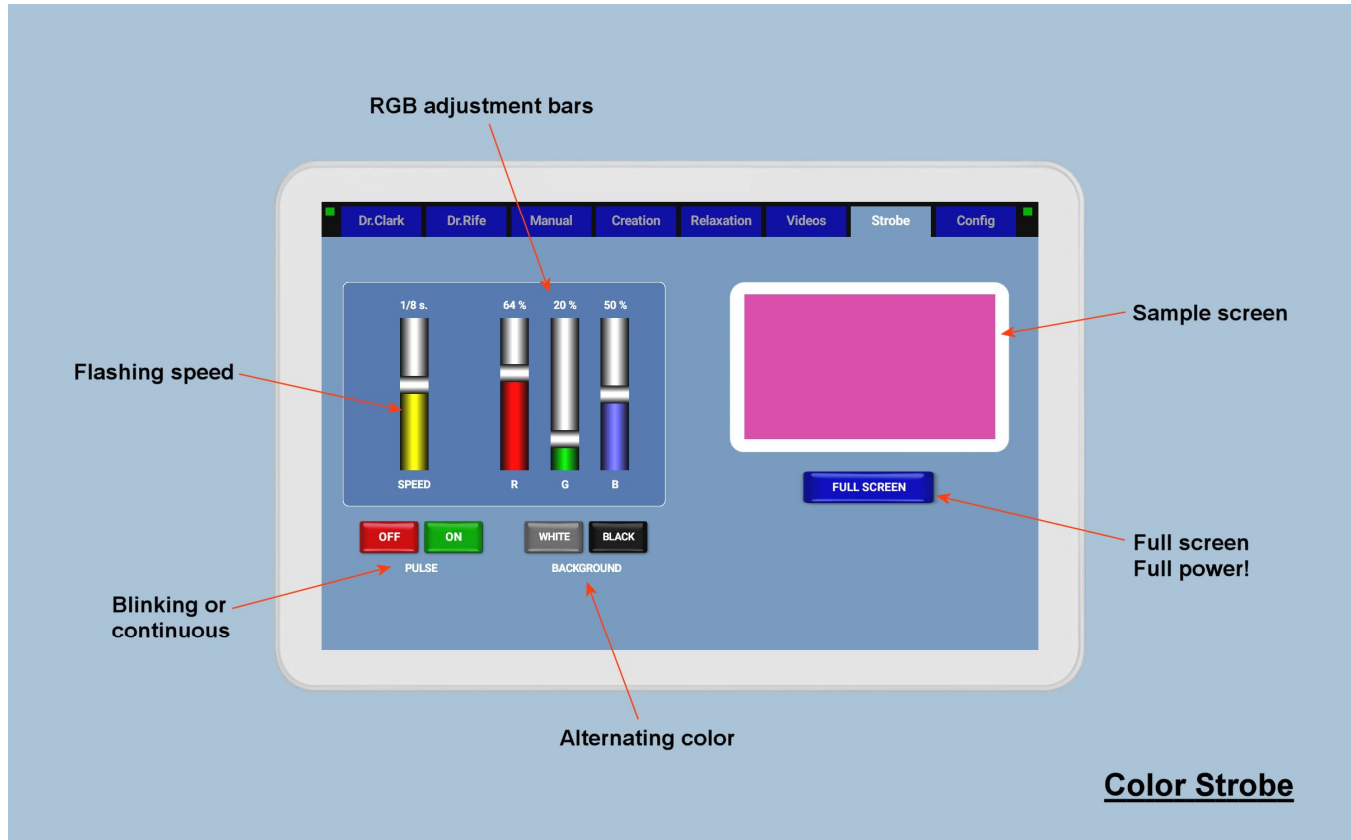

7.1 Its usefulness

Much research has shown that certain diseases can be treated by exposure to certain colors and pulses of light. Alzheimer's and several eye diseases are very good examples. Light therapy device is another common example.

7.2 How it works

First of all, choose a color to display. The color is created from the three adjustment bars RGB, **R** for **RED**, **G** for **GREEN** and **B** for **BLUE**. This color system widely used in computer science is called "**subtractive**", meaning that the more you increase the gain of a channel, the lighter the color becomes.

Example: **R** =100%, **G** =100%, **B** =100%, the color produced is **WHITE**.

And: **R** =0%, **G** =0%, **B** =0%, the resulting color is **BLACK**.

The color thus created is visualized in the miniature tablet on the right. To use the strobe function, simply press the **ON** button and adjust the flashing speed with the left bar.

The **WHITE** and **BLACK** buttons are used to set the background of the screen when blinking. Example: If your chosen color is **YELLOW**, it is preferable to choose a **BLACK** background to obtain an alternation with maximum effect. Now: If your chosen color is **DARK BLUE**, here it will be more appropriate to use a **WHITE** alternation to create a better contrast.

Once you are satisfied with your creation, all you have to do is press the **FULL SCREEN** button to switch to full screen mode. The brightness automatically rises to maximum in full screen mode to give as much effect as possible.

7.3 The strobe remote control

Here we still have a translucent remote control similar to the one in the videos section but much simpler. You can make it appear by touching anywhere on the screen. The four adjustment bars serve exactly the same purpose as in the previous screen. These adjustments are also stored in the tablet. The buttons are very simple, **HIDE** to hide the remote control and **EXIT** to exit the full screen mode and return to the previous screen.

8 Other

8.1 Total Security

For a device to be used by a person, it is essential that its security is 100%. Here, everything has been designed to achieve this level of security without making any compromises.

This device contains several protective elements for your safety. From the power supply to the output, everything has been done to eliminate any risk.

Each device is rigorously inspected on an oscilloscope and passes an insulation test before being packed. This product is meticulously designed and manufactured in Canada.

8.2 Disclaimer

This product has not been licensed as a medical device, it may be used as an experimental device only for individual or educational research. **The use of this device is at your own risk.**

If you are **pregnant** or if you are wearing an electronic **pacemaker**, **do not use it.**

8.3 Warranty

A one-year warranty covers all repairs or replacements for normal use. Each assumes the cost of shipping to send the product.

Although the tablet is a standard model, this tablet should only be used for TotalZap. Connecting it to the Internet and downloading programs and games can cause problems and automatically voids your warranty.

8.4 Contact Us

All emails will be replied within 24 hours. Do not hesitate to contact us for any questions or comments concerning our products or your need.

TotalZap@sce-technologie.com

9 Technical Data

Frequency Range	1Hz - 1MHz
Frequency Resolution	1Hz
Frequency Accuracy	0.01%
Time accuracy	0.001 sec.
Amplitude Range	2V - 16V (peak to peak)
Amplitude Resolution	1V Steps
Output Waveforms	Square and Sine
Duty Cycle (Ratio)	5% - 95%
Positive DC Offset	+0.25V
Output Impedance	1K ohms
Output Current	3.5mA max.
Processor & DSP	240MHz & 125MHz Cristal Controlled
Communication	WiFi 802.11 b / g / n
Display / Controller	Color High Resolution 1.3GHz Quad Core Tablet
Tubular Electrodes	2 Stainless 316 Tubes 175mm x 22mm (7" x 7/8") with all connectors gold plated
Foot Plates	2 Stainless Foot Plates 230mm x 95mm (9" x 3 3/4") with all connectors gold plated
Power Supply	120/230VAC to 9VDC 1A Adapter CE / UL Certified